

ADDING AN EXTENSION TO YOUR FLOWER WALK PERGOLA

EXTENSION HARDWARE PACK

① CURVED SECTION	6
② FOOT	2
③ METAL RODS	7
a WASHERS	14
b PLASTIC CUP	7
c CAPS	7

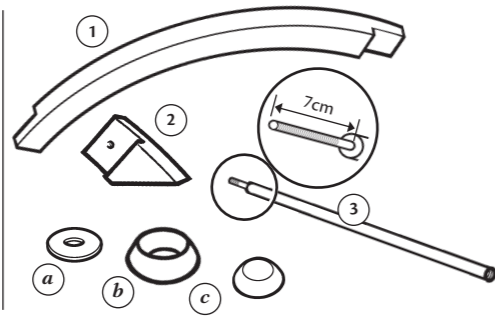

STEP 22
Glue and screw the curved beams as steps 2-4.

STEP 23
Fix the feet to the curved beam assembly as steps 4-6.

ALLOW THE GLUE TO SET OVERNIGHT.

STEP 24
Mark the positions for the feet.

STEP 25
Remove the Plastic Caps (c) from the ends of the assembled Flower Walk that is to be extended

NB. replacement cups and caps are supplied.

STEP 26
Remove the Plastic Cup, if fitted, and undo the M10 nut. Discard the old cups and caps.

STEP 27
Screw one of the metal rods from the extension pack into one of the positions just released. Ensure the metal washer is fitted.

STEP 28
Screw the remaining six metal rods into the existing structure.

STEP 29
Fit washers between the metal rods and the curved beam assembly.

STEP 30
Fit the curved beam assembly using the replacement cups and washers.

Fix in place using either the M10 bolt or M10 nut previously removed.

STEP 31
Now tighten the metal rods into the existing structure. Once they are all tight, tighten the M10 bolt or M10 nut.

STEP 32
Finally, fit the caps to the plastic cups.

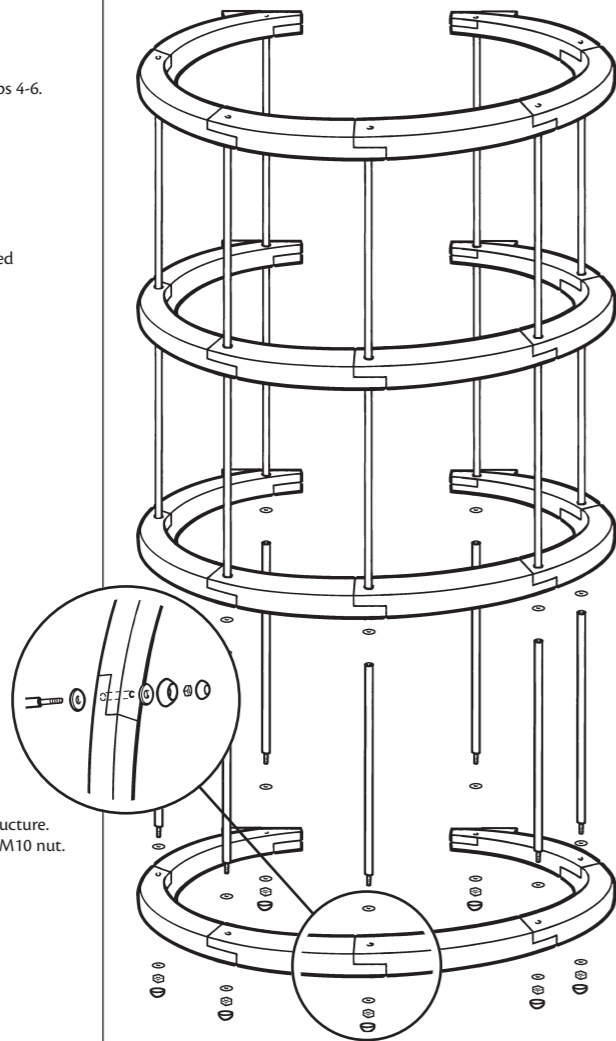

THE EXTENSION AS PART OF THE INITIAL BUILD

Any number of extensions may be added to the basic pack. The extension pack provides all of the parts required to build a longer Flower Walk by following the main instruction procedure.

TIP
An attractive addition to the Flower Walk is to fit border troughs along the sides.

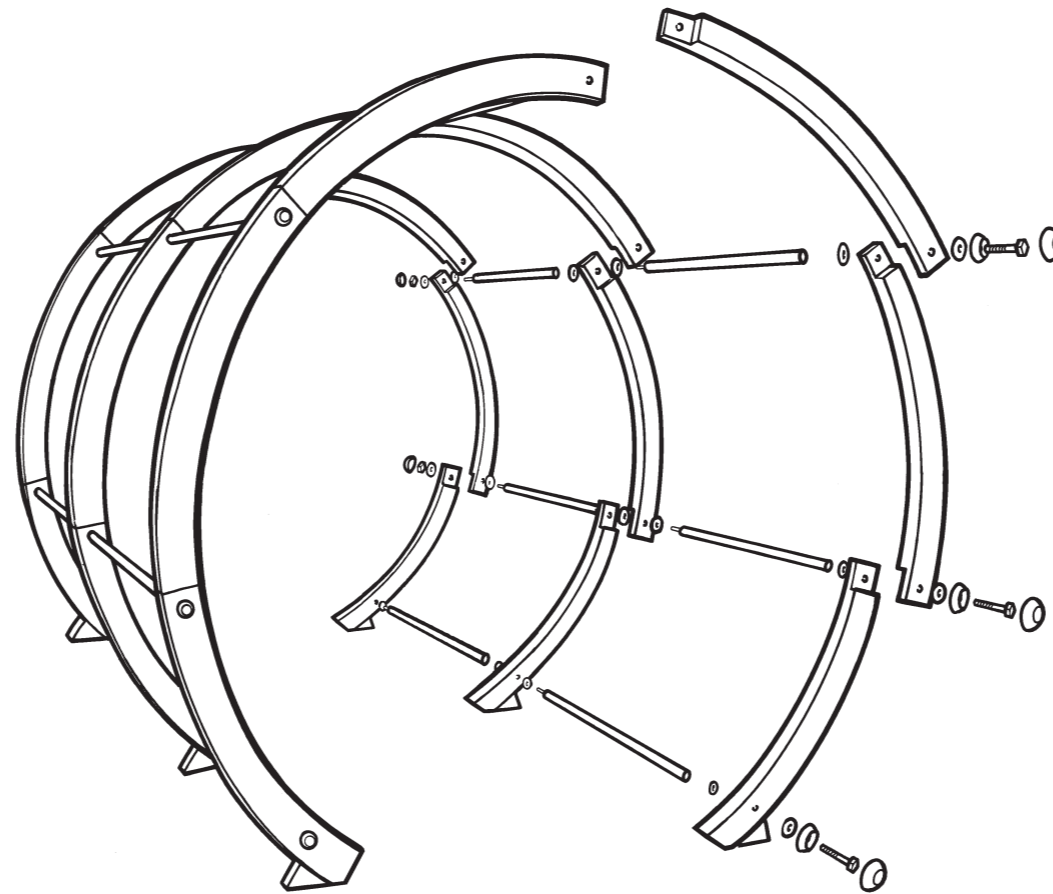

AFTERCARE

To ensure longevity of your structure it is recommended that it is treated with a wood preservative on a yearly basis.

Grange
DEFINING GARDENS

FLOWER WALK PERGOLA [PACK A]

FLWCCL - 228cm [H] x 240cm [W] x 258cm [D]

Self-Assembly required Home Delivery available Pre-Painted available

PLAN

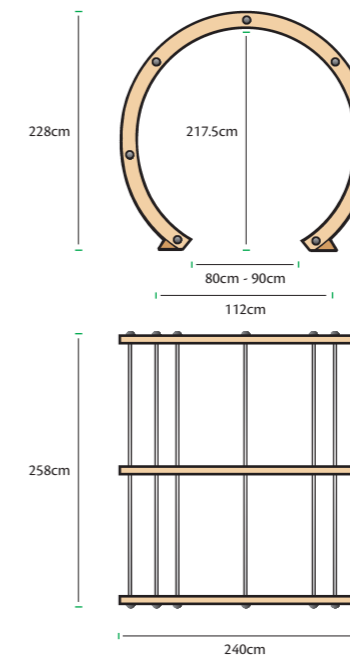

CODE: FLWCCL

©2015 Grange Fencing Ltd All rights reserved. In line with the Company's policy of continuous product development, the right is reserved to change and improve product design without prior notice.

All products and related emblems featured are trademarks of Grange Fencing Ltd.

www.grangefen.co.uk



Thank you for choosing this garden structure from Grange.
PLEASE READ THE ASSEMBLY INSTRUCTIONS THOROUGHLY BEFORE ATTEMPTING TO ERECT THE STRUCTURE
 ESTIMATED BUILD TIME - 6 HOURS (OVER TWO DAYS)

TOOLS REQUIRED (Not Supplied)

- POWER DRILL
(+ crosshead screwdriver bit)
- SPIRIT LEVEL
- TAPE MEASURE
- STEPLADDER
- 1.7cm BI-HEX SOCKET + HANDLE

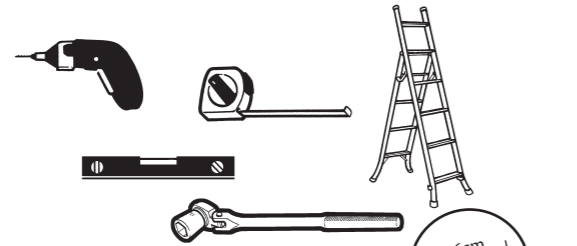

PARTS LIST

- | | | |
|---|------------------|----|
| 1 | CURVED SECTION | 18 |
| 2 | FOOT | 6 |
| 3 | METAL RODS (7cm) | 7 |
| 4 | METAL RODS (6cm) | 7 |

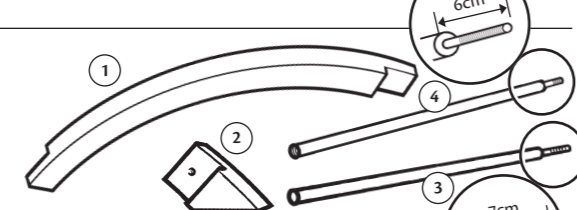

HARDWARE PACK

- | | | |
|---|-------------------|----|
| a | WASHER | 42 |
| b | PLASTIC CUP | 14 |
| c | CAP | 14 |
| d | 10mm NUT | 7 |
| e | M10 x 70 HEX BOLT | 7 |
| f | M4 x 40 SCREW | 66 |
| g | WOOD GLUE | 1 |

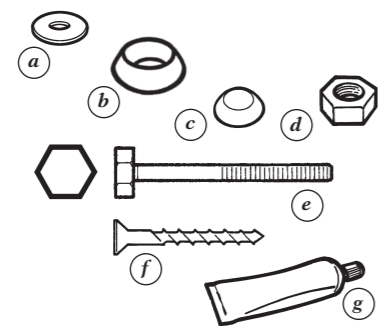

BEFORE YOU START

- Please ensure that you check all the component parts for quantity and quality before you commence building the product. Report any missing parts immediately. The manufacturer will not accept any responsibility for damaged items once any part of the product has been fitted or altered in any way.
- Timber is a natural material and will react to varying levels of moisture content - ie. will swell or shrink. All of the Timber components are pressure treated green. However, should extra protection be required, they should be treated using a wood preservative treatment, following the maintenance instructions.

HEALTH AND SAFETY

Do not overstretch when working from the step ladder.
 In order to reduce the risk of suffocation please keep all plastic bags and small parts away from children.

- When you are ready to start, make sure you have the right tools to hand, plenty of space and a clean, dry area for assembly. **It is advisable for two people to carry out the work.**

PREPARATION

Make sure the area where the Flower Walk is to be positioned is clear and ready for building the structure.

ASSEMBLY INSTRUCTIONS

PART ONE

To ensure a sound structure, it is recommended that the sections which form the Circle are assembled and glued then allowed to set for 24 hours before continuing.

STEP 1

Make sure you have a clean, flat dry area, big enough to assemble a circle.
 (see Pergola 'footprint' - right - for dimensions).

Remember - the circle, once assembled will need to be left undisturbed for 24 hours.

STEP 2

ASSEMBLING THE CIRCLE

Take two of the curved sections and apply glue to one of the joint faces. Fix the joint together and screw in place using two screws (f).

STEP 3

Continue from one end of the assembly with the next curved section repeating step 2.

STEP 4

Fix three more curved beams in the same manner.

STEP 5

Take one of the Feet (2) and fix to one end of the circle assembly (as fig.2).

STEP 6

Repeat the procedure for the other end of the circle assembly.

STEP 7

Repeat steps 2-6 for the two remaining circles.

STEP 8

Lay the circles on top of one another (as fig.3). Leave for 24 hours for the glue to set fully.

ASSEMBLY INSTRUCTIONS

PART TWO

STEP 9

Mark the hole positions for where the metal rods will be fixed.

The position should be in the centre of the joints except for the two joints for the feet. These should be marked in the centre of the beam 15cm from the end.

STEP 10

Now, using the 1.2cm drill bit make a hole through all three circles at the marked points. This is to ensure correct alignment of the structure.

STEP 11

Place the assembled circles as close as possible to their final positions (see footprint at top of page).

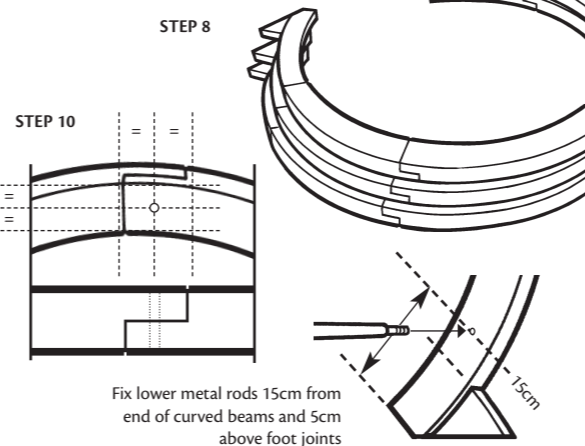
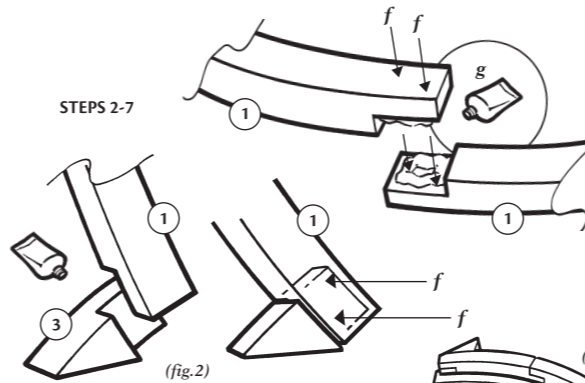
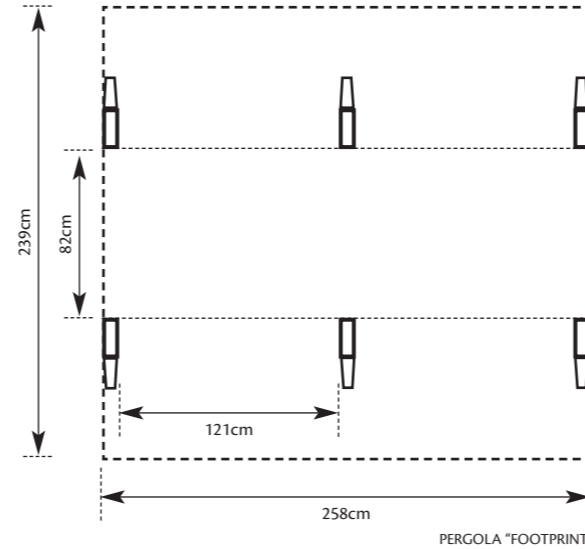

STEP 12

Take one of the Metal Rods (3) with the 7cm thread and fix it to one of the end curved beam assemblies (as shown in fig.6).

Tighten bolt (e) using a 1.7cm socket.

STEP 13

Fit metal rods to the remaining six holes for the circle assembly as in step 12.

STEP 14

Fit Washers (a) to the threaded ends of the metal rods.

STEP 15

Fit the next circle assembly over the protruding threads.

STEP 16

Fit a Washer (a) and a metal rod (4) with the 6cm thread to each of the threads protruding through the circle assembly. Tighten the rods in place as tight as possible.

TIP

Keep working around the rods in turn to tighten them.

STEP 17

Fit washers to the metal rod threads and then fit the remaining circle assembly.

STEP 18

Fit washers to the protruding threads before fitting a Plastic Cup (b) and M10 nut (d).

Tighten the nuts using a socket as before as tightly as possible.

STEP 19

Using the dimensions of the completed structure, mark the positions for the feet.

STEP 20

Ensure the structure is aligned correctly.

STEP 21

Once the structure is fixed in its final position and securely fastened down, fit the caps (c) to the plastic cups.

NB. Once the caps are fitted they cannot easily be removed without incurring damage.

FOR DETAIL OF ADDING AN EXTENSION TO THE EXISTING FLOWER WALK SEE OVERLEAF.

